

1965-1966 Ford Full Size Truck, Standard Cab F100/F150 Headliner

Tools needed: Tape Measure, Phillips screw driver, sharpened pencil, 1" wide masking tape.

Step 1

Measure the distance "A" from top of mirror bracket to the SMALL screw hole near the center of the roof reinforcement.

Measure "B" from panel above door to the same screw hole.

Using the masking tape, start at the front of the panel above the door opening and continue down along the back.

On the masking tape, mark the location of the screw holes that will hold the headliner in place. This is necessary for you to locate the screw holes after they are covered when the headliner panels are put into position.

Step 2

Place the headliner with the front edge into the clips attached to the headliner panel above the windshield.

Using the hole punch, locate and puncture the holes in the headliner and screw it into place.

Using measurements "A" and "B" locate the center hole on the headliner and screw into place.

Step 3

Each rear corner panel can be placed in position and attached. The surfaces next to the rear window will tuck behind the rubber seal.

Step 4

The upper rear headliner panel is positioned by placing the front edge into the clips into the back edge of the front headliner panel.

Again, the surfaces of the headliner next to the rear window will tuck behind the rubber seal.

Helpful Tip:

We have found from experience that by dampening the headliner material with water, it becomes more flexible and less likely to break during installation.

Using a spray bottle filled with water, lightly spray the BACKSIDE of the side panels and the rear part of the headliner next to the rear window until the material becomes softer so that it can be formed more easily by hand.

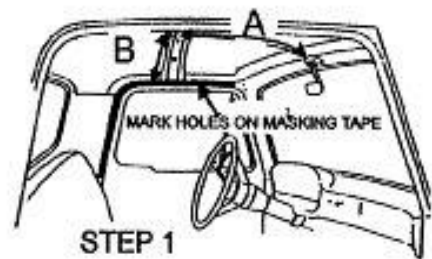

STEP 1



STEP 2

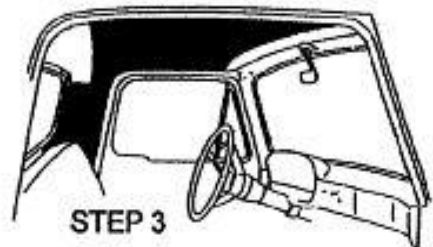

STEP 3



STEP 4